

ALDEN T. & JENNY M. GREENWOOD
670
2927/703 10/10/79

APPROVED BY THE MADISON A. ALVING BOARD
ON _____ CERTIFIED BY _____
CHAIRMAN: _____ AND _____
SECRETARY: _____

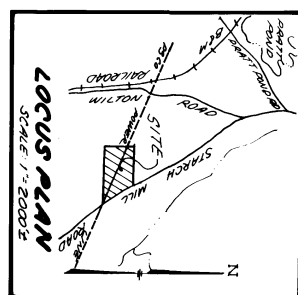

REFERENCE PLANS:

- 1) "LAND OF ALMA MUMFORD - MASON, N.H. -
1" = 100', 1978" BY JOHN PRESTON -
SURVEYOR, H.C.R.D. #1261.
- 2) "PLAN OF R.O.W. PURCHASED FROM ALMA
MUMFORD - IN THE TOWN OF MASON, N.H.
BY PUBLIC SERVICE CO. OF NEW
HAMPSHIRE ENGINEERING DEPARTMENT" -
SCALE: 1" = 200', OCT. 2, 1969.

NOTES:

- [illegible]

"THE SUBDIVISION REGULATIONS OF THE TOWN OF MASON ARE A PART OF THIS PLAN, AND APPROVAL OF THIS PLAN IS CONTINGENT ON COMPLETION OF ALL THE REQUIREMENTS OF SAID SUBDIVISION REGULATIONS, EXCEPTING ONLY ANY VARIANCES OR MODIFICATIONS MADE IN WRITING BY THE BOARD AND ATTACHED MEMORO."

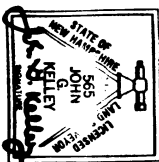

DAVID L. & AILA C. SOMERO
MASON, N.H.
PREPARED FOR
CADIEUX REAL ESTATE

PREPARED FOR

MASON. N.H.

SCALE: 1"=100

REV. MARCH 6, 1984

**THOMAS F.
MORAN INC**

MORAN inc.
surveyors
civil engineers
land planners

55 South River Road (Rt. 3)
Bedford, NH 03102

13 Nashua Street
Milleduff, NH 03056

P.O. Box 272 U.S. Rte. 231
Kittery, Maine 03904

**surveyors
civil engineers
land planners**